

PRISME



atech



TABLE OF CONTENTS

PRESENTATION	4
TECHNICAL DATAS	6
LAYOUTS	12
SCENARIOS	14
OPTIONS	16
REGISTERED DESIGN	18

PRISME

THE VEGETAL ISLAND

Prisme forms part of a sustainable city vision where life, in all its forms, blossoms. Where nature is accepted with its virtues and its defaults. Left behind for too long, it is now an important component in the development of our cities. To help this transition, Prisme turns out to be the ideal solution to recover nature in artificial urban areas. During a short stay, users will enjoy to be in the heart of greenery. Its refined and geometric style make Prisme an atypical layout which sublimate your spaces.





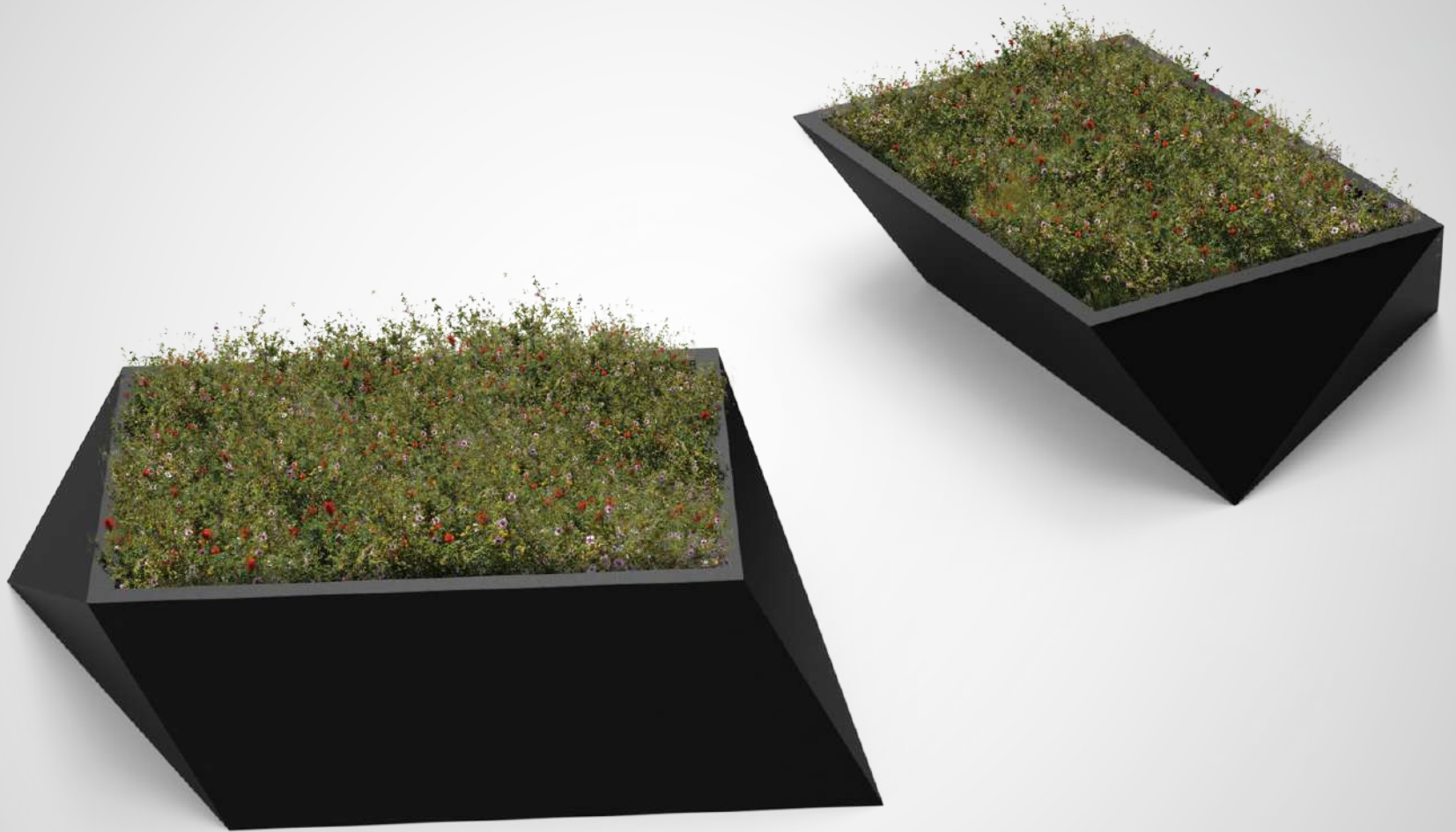

1
PLANTER

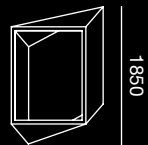

Substrate volume | 500 l.

Tare weight | 100 kg

Materials & Finishes | Steel structure th. 3 mm anti-corrosion treatment and hot-lacquered, RAL colors of your choices, slats in FSC-PEFC wood, moveable with pallet jack, water reserve with overflow

Fixing | To put on the ground

Model | Association possibility with Prisme ④ and ⑤

Variants | Planters in corten steel or stainless steel, bottomless



2

BACKLESS BENCH

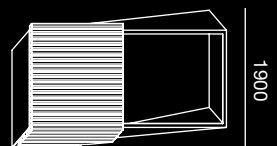

3

BENCH

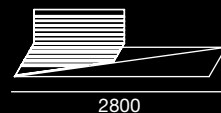
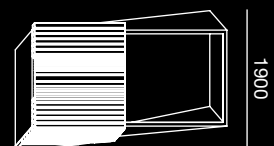

Substrate volume | 1400 l.

Tare weight | 300 kg

Materials & Finishes | Steel structure th. 3 mm anti-corrosion treatment and hot-lacquered, RAL colors of your choices, slats in FSC-PEFC wood, moveable with pallet jack, water reserve with overflow

Fixing | To put on the ground

Model | Association possibility with Prisme ④ and ⑤

Option | Shelf

Variants | Planters in corten steel or stainless steel, bottomless

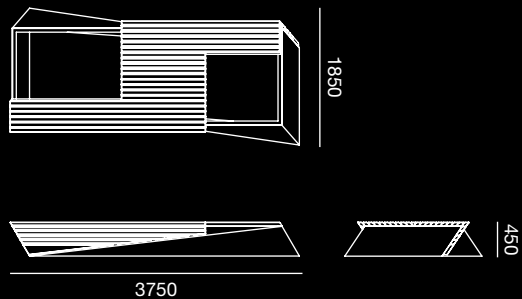

4

BACKLESS BENCH

5

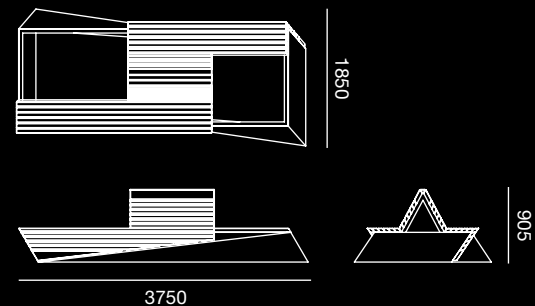
BENCH**Substrate volume** | 1900 l.**Tare weight** | 600 kg**Materials & Finishes** | Steel structure th. 3 mm anti-corrosion treatment and hot-lacquered, RAL colors of your choices, slats in FSC-PEFC wood, moveable with pallet jack, water reserve with overflow**Fixing** | To put on the ground**Model** | Association possibility with Prisme ①, ② and ③**Option** | Shelf**Variants** | Planters in corten steel or stainless steel, bottomless

PRISME

LAYOUT SOLUTION

The modules of Prisme range, single or accompanied, answer the needs of users. The different combinations will landscape a unique urban garden, adapting itself to you area.



A

1 - 5 - 1

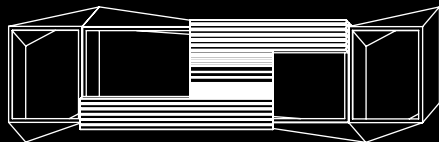

5750 x 1850

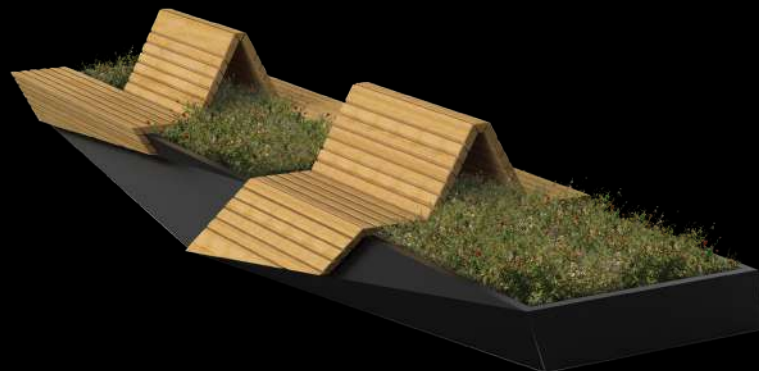

B

3 - 5

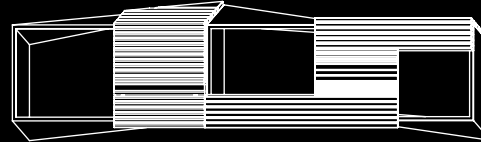

6350 x 1900

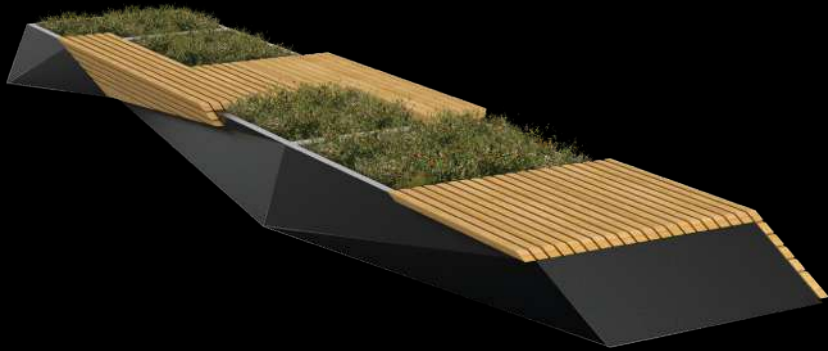

C

1 - 4 - 2

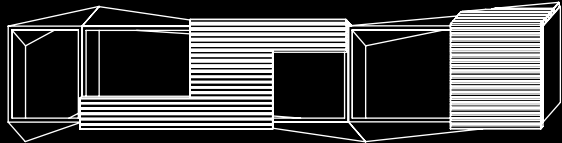

7350 x 1900



D

4 - 1 - 5

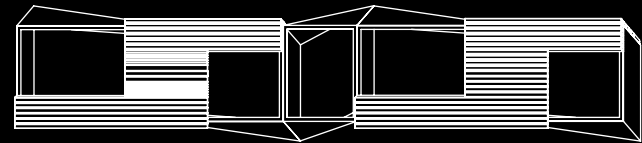

8400 x 1850

PRISME

BIODIVERSITY SUPPORT

More than street furniture, Prisme is a space where human and nature will coexist, an experience which will awake senses. This unique layout will allow users to rest, to eat, to discuss. Thanks to its big planters, it will receive a dense and luxurious vegetation, optimal for a lot of animal species. The users will then can observe nature blooming during the whole year.

COMBINATION OF THE MODULES 1 - 5 - 2



FLOWERS

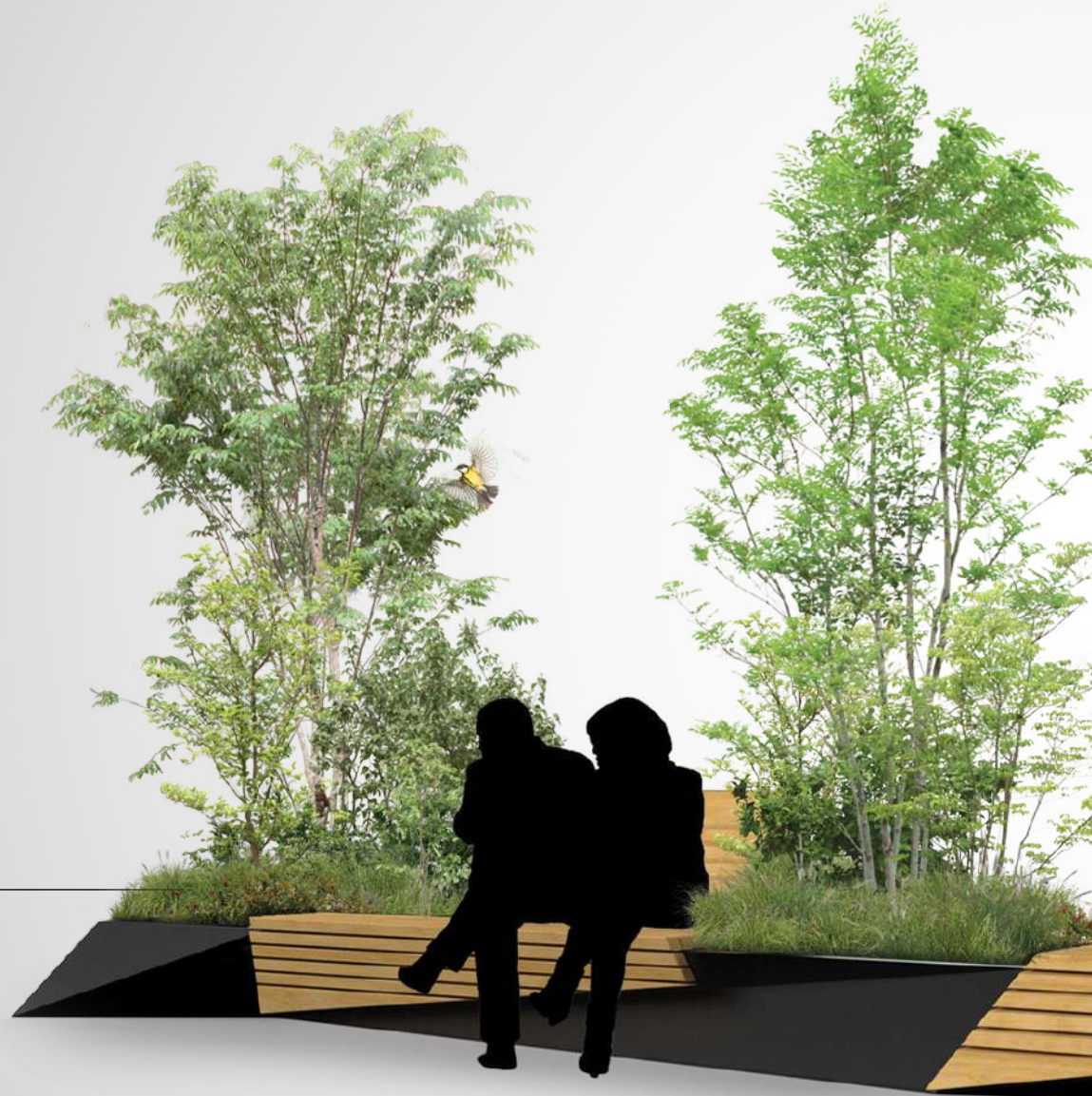

FRUITS



A local and diversified vegetation must be favoured to help different insect species, birds and little mammals. During the beautiful season, insects will can feed with flowers and contribute to pollination. Tall weeds and twigs will serve as materials for birds' nests and constitute plentiful shelters for insects. The latter will be the delight of birds which will feed their babies with it. During winter, birds will feed themselves with fallen seeds, insects will hibernate under plants and the micro fauna of the soil will decompose dead leaves. Regarding human, he will ensure the management and balance of this urban oasis.



PRISME

ADAPT ITSELF TO YOUR PROJECTS



HOT-LACQUERED STEEL

PURPLISH RED - RAL 3004 - MAT



HOT-LACQUERED STEEL

SULFUR YELLOW - RAL 1016 - GLOSSY



CORTEN STEEL
STABILIZED



STAINLESS STEEL
BRUSHED

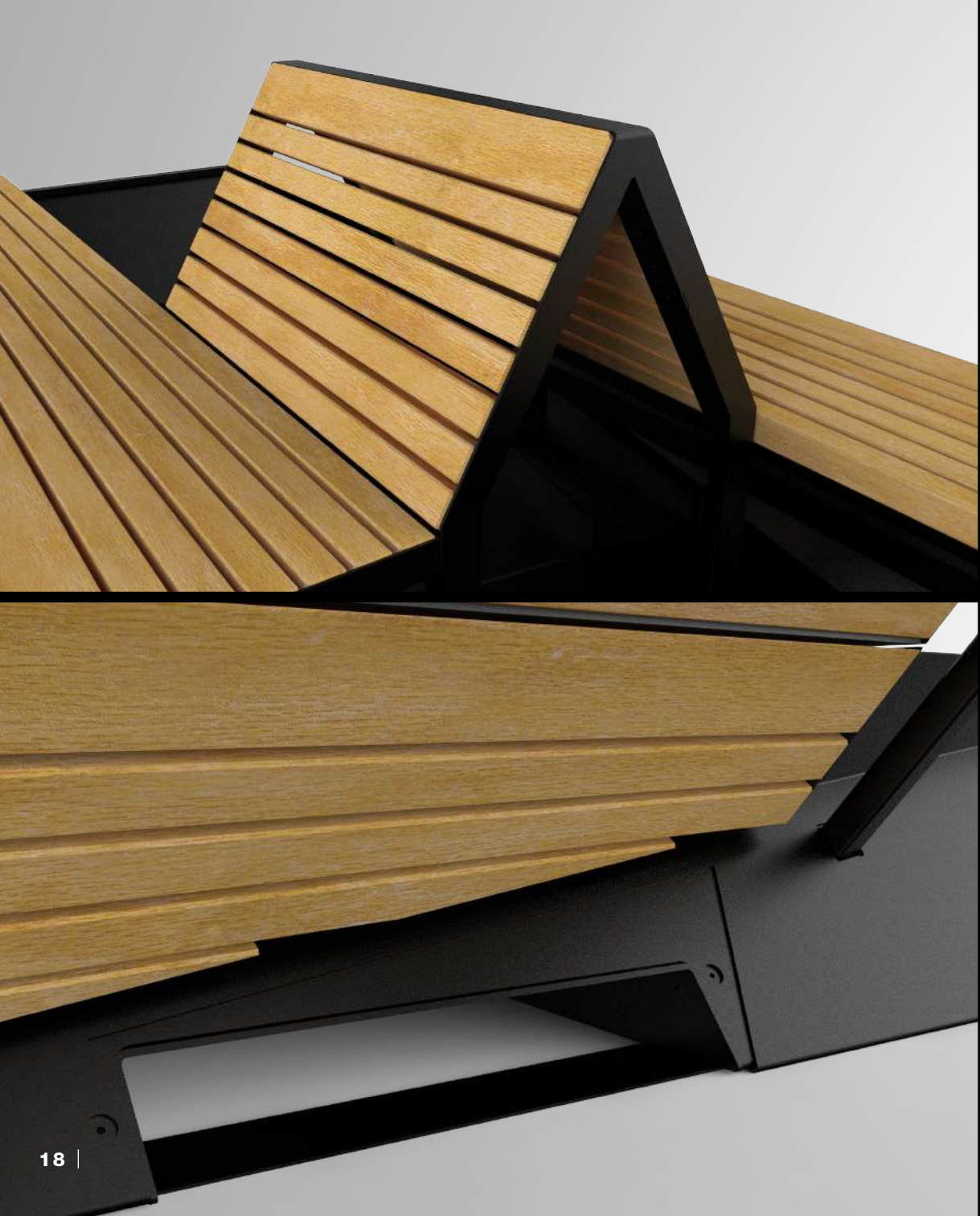

Non-binding document. Atech reserves the right to update whenever needed, without notice, its creations.
Any reproduction without our prior agreement is forbidden.



atech
www.atech-sas.com